

INSTALLATION OF ROOF CONSOLE

LANDROVER DEFENDER 110 WAGON – 01/02 ON ... PART NO: RCDEF02

****SUN VISOR ALTERATION:** When installing the Roof Console in a Landrover Defender, 100mm has to be cut off from the mirror end of the sun visors so they are square. This alteration is unavoidable and must be made to allow visors to fit with Roof Console. We recommend that a motor trimmer is used to alter visor ends.

For this installation you will need a 3.5mm 'stubby' drill bit, small electric drill, electrical insulation tape, **hand held** Phillips screwdriver, **short** Phillips screwdriver, 8mm socket and ratchet, small flat blade screwdriver (lever tool) 2.5mm Allen key & 'Loctite'. **Use Loctite on all console screws when installing.**

Vehicle preparation: **Remove Sun Visors and cut 100mm off of ends as described above.

Switch your interior light to 'off' position and remove from roof; to do this insert small flat blade screwdriver (lever tool) into lens slot and prise out. Use 8mm socket to undo 8mm nuts and remove earth plate from roof. Put interior light back together and store away for restoration of vehicle at a later date.

Remove rear view mirror; to do this, pull mirror toward you to dislodge it from mirror bracket. Remove mirror bracket. **Note:** Original screws in mirror bracket are only made of 'soft' steel; if a screw head strips drill out head of screw and use vise grips to remove stem.

Front Mount Bracket installation: Hold Front Mount Bracket over original mirror screw holes and fasten mirror bracket back in place over Front Mount Bracket using three 4mm x 20mm countersunk socket head screws supplied.



Rear Mount Plate installation: Insert 'stubby' 3.5mm drill bit into drill chuck ensuring **only 25mm** of drill bit is showing. There is a join in the roof lining just behind rear of front seat, hold Rear Mount Plate so turned up edge of plate fits **up** into join in roof lining. Hold plate in **centre** of centre roof rib and ensure captive nuts in plate point **down** and are to **rear** of vehicle (PIC 2). Drill up through **marked centre hole** in line with captive nuts in Rear Mount Plate (PIC 3). Fasten plate through centre hole to roof rib using 8# x 20mm Phillips self tapping screw supplied (PIC 4). Drill through the two holes on either side of captive nuts (PIC 5). (**Note:** You are only drilling into roof support not into the roof itself - three grey snap caps and washers are supplied to cover these holes upon removal of console. Store these with interior light for use at a later date). **Remove** 8# x 20mm screw and slide Rear Mount Plate **forwards**. Fasten plate to roof rib through the **three centre** holes using three 10# x 20mm Phillips self tapping screws supplied. Do up firm only; **do not** over tighten so as to strip screws (PIC 6).



PIC 2



PIC 3



PIC 4



PIC 5

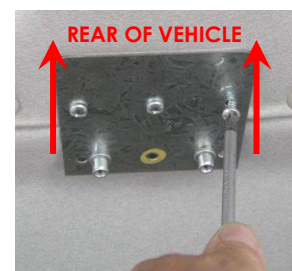

PIC 6

Comfortable work position: Slide seats all way back, if right handed, sit in passenger seat; if left handed sit in driver seat.

Installation preparation: Connect wiring extension supplied to console wiring loom; red to red, white to white and yellow to yellow. Tape up connections individually.

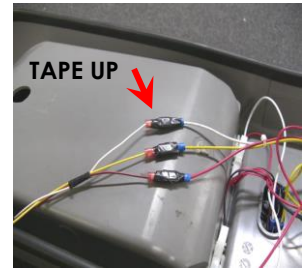

Stand console upright on front seat and plug console wiring into interior light wiring of vehicle; plug white wire from console into brown/white wire of interior light plug, red into brown wire and yellow into black wire. Close doors and check that lights are working correctly then tape up to ensure wires do not become disconnected.



There is an 'on/off' switch located above radio opening. When 'off' it acts as a kill switch-- no lights will work. When 'on' lights work independently as map/interior lights when doors are shut and timer switches off. When doors are opened lights work as door/interior lights.

Use 'Blu-Tack' in fit kit to adhere one of the 6mm x 30mm round head bolts to hand held Phillips screwdriver, put a small amount of 'Loctite' on thread and store in convenient location, eg: on seat of vehicle or in/on centre console.

Console installation: Hold console up in position over Front Mount Bracket ensuring mount bracket slides/fits in between front of console and rear of radio surround. Look up under rear mounting hole and line up captive nuts in Rear Mount Plate with slotted fastening holes. Use the 6mm x 30mm round head bolt 'Blu-Tacked' to your hand held Phillips screwdriver to loosely fasten console up to Rear Mount Plate. 'Blu-Tack' other 6mm x 30mm round head bolt to screwdriver, apply 'Loc-Tite' and loosely fasten into Rear Mount Plate.

Using a short Phillips screwdriver fasten front of console to Front Mount Bracket using the two 6mm x 16mm black round head Phillips bolts; to do this push up firm on front of console and do bolts up tight.

Important note: Mirror bracket screw holes may vary from one vehicle to another thus affecting the position of Front Mount Bracket and Console. If rear of Console is not a snug fit to roof contours (as pictured below) then elongate holes in Front Mounting Bracket to allow console to move either backwards or forwards as required.



Replace rear view mirror; push up hard on rear view mirror to snap back in place - mirror base will sit flat on countersunk socket head screws.

Now tighten rear bolts. **Note:** *only tighten rear bolts up firm so as console is held to roof, do not keep on tightening so as to bend rear Mount plate downwards; do rear bolts up with equal tension.*

Open Locker Box and remove Microphone Cable Holder and Rear Mounting Hole Cover from inside; fasten Hole Cover in place using screws supplied. Fasten Microphone Cable Holder in place as per radio installation instructions.

Fit Kit: RCDEF02

- 1 - Wiring extension
- 1 - Front Mount Bracket
- 1 - Rear Mount Plate.
- 1 - 8# x 20mm Phillips head screw.
- 2 - 6mm x 16mm **black** Phillips round head bolts
- 2 - 6mm x 30mm Phillips round head bolts
- 3 - 4mm x 20mm countersunk socket head set screws
- 3 - Plastic snap caps - **grey**
- 3 - Plastic snap cap washers
- 3 - 10# x 20mm Phillips head screws
- 1 - Small piece of 'Blu-Tack'
- 3 - 100mm sticky back foam pieces

RADIO INSTALLATION

Radio Insert Installation: for smaller size radios

PLEASE NOTE: Radio Inserts NOT INCLUDED.

Decorative side of insert faces outwards and snaps out over bottom of tray surround.

To install insert, squeeze top and bottom together; push/bend sides and squeeze into tray surround from inside to outside until bottom lip on decorative side of insert snaps/pops out over bottom of tray surround, prize with fingers to ensure bottom lip of insert is in place over tray surround as described. **Do not** scratch or mark insert or surround by prising/levering with tools; use hands/fingers only.



Radio Installation:

Place protective cover on work bench to avoid scratching console. Place console on protective cover and using a sharp knife cut a 30mm x 100mm section out of storage tray 25mm in from where rear of radio will be when installed. Use a small amount of methylated spirits on a clean cloth to clean exposed part of console and bottom rear of radio.

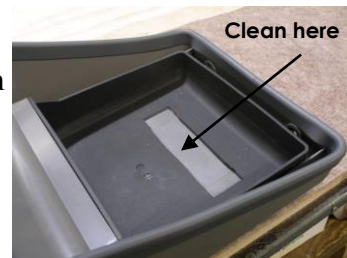

Peel one side of protective backing from foam strip supplied; apply pressure with palm of hand to adhere foam to exposed part of console. Peel backing off other side of foam strip and add one or more strips of foam to suit different size radios (see chart below). This will keep radio level with bottom of surround.



Insert radio on an angle until radio protrudes 15mm out over bottom of tray surround or insert and straighten; lay flat onto sticky back foam and apply firm pressure to top of radio with palm of hand for 30 seconds to ensure good adhesion.



Sticky back foam chart:

- One (1) strip- standard size radios
- Two (2) strips- Icom and Uniden
- Three (3) strips- GME Electrophone

Microphone and Microphone Cable Holder installation:

Install in a position that suits best, depending on vehicle and Radio model. Ensure microphone or microphone cable and holder does not foul on sun visor when pulled down.



Microphone clip on slight angle



Left hand cable outlet radios



Microphone clip on acute angle