

Hilux

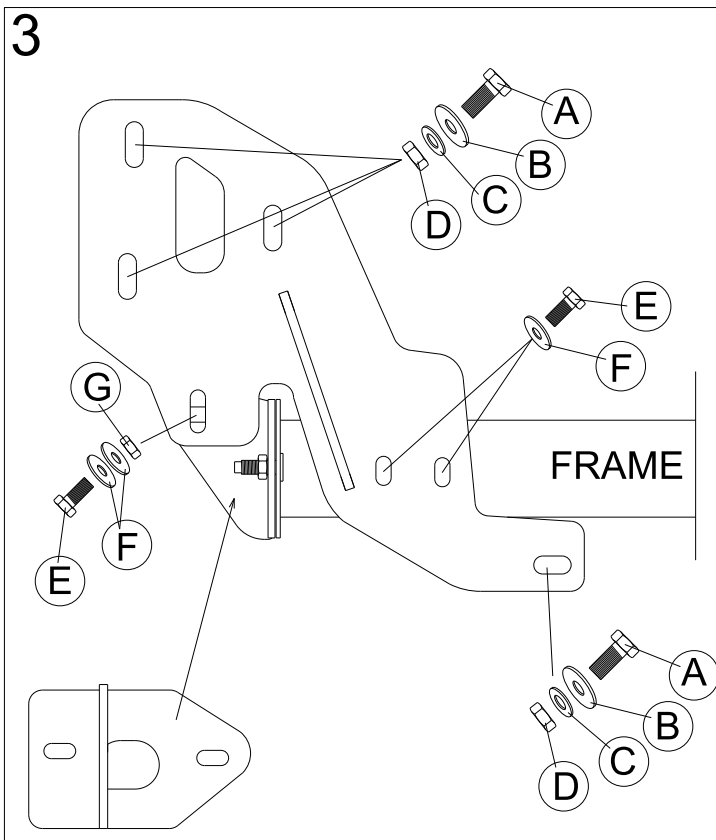
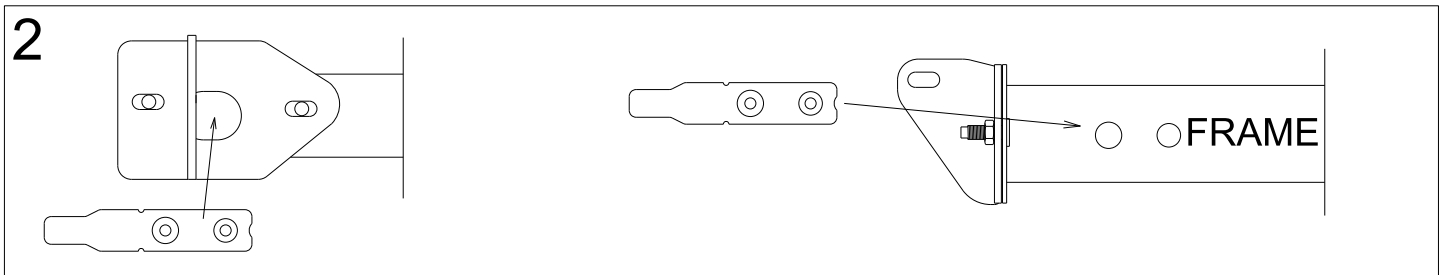
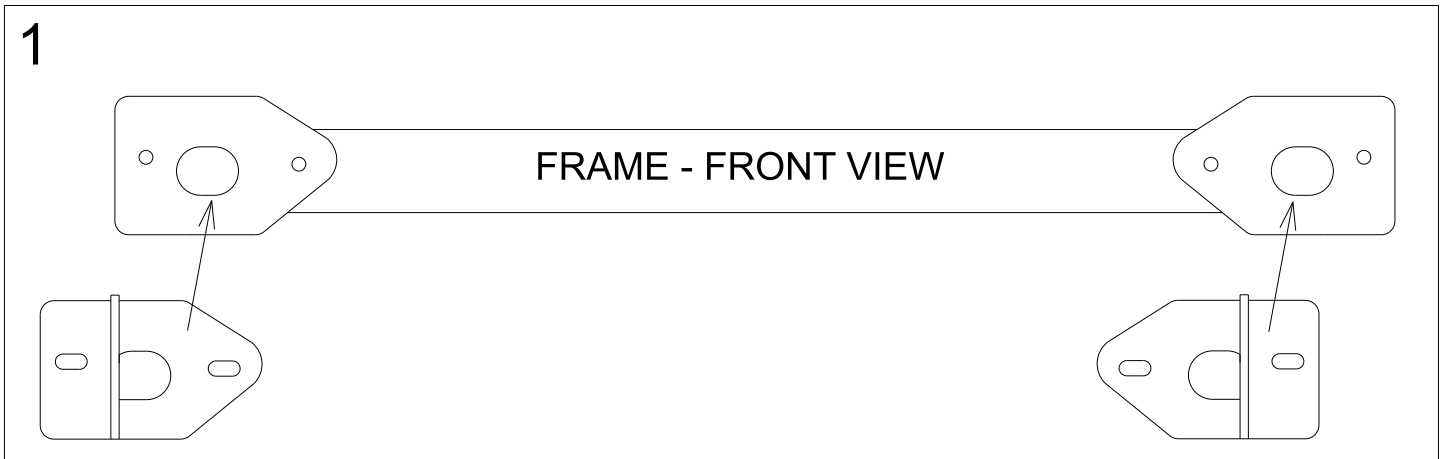
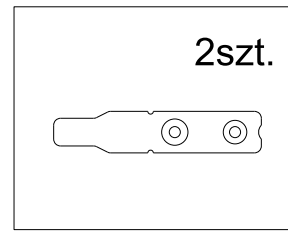
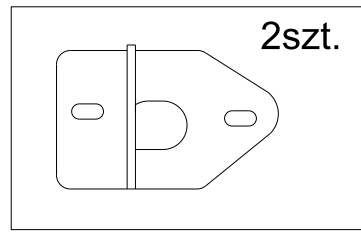
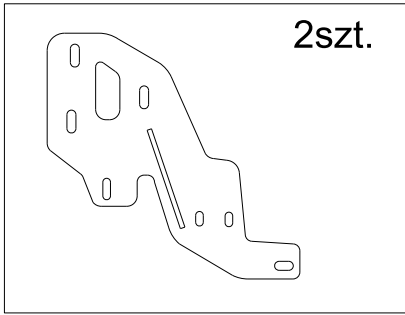

A - bolt M12x40	- 8szt.
B - washer $\phi 12 \times \phi 35 \times 6$	- 8szt.
C - washer $\phi 12$	- 8szt.
D - self-locking nut M12	- 8szt.
E - bolt M10x40	- 6szt.
F - extend washer $\phi 10$	- 8szt.
G - self-locking nut M10	- 2szt.