

ASSY INFO	MASS (kg):	
	BONDED:	
	FASTENED:	Y
FINISH	WELDED:	
	TUMBLING:	
	BRUSHED:	
	POWDER:	
	SPRAY:	
	COLOUR:	N/A

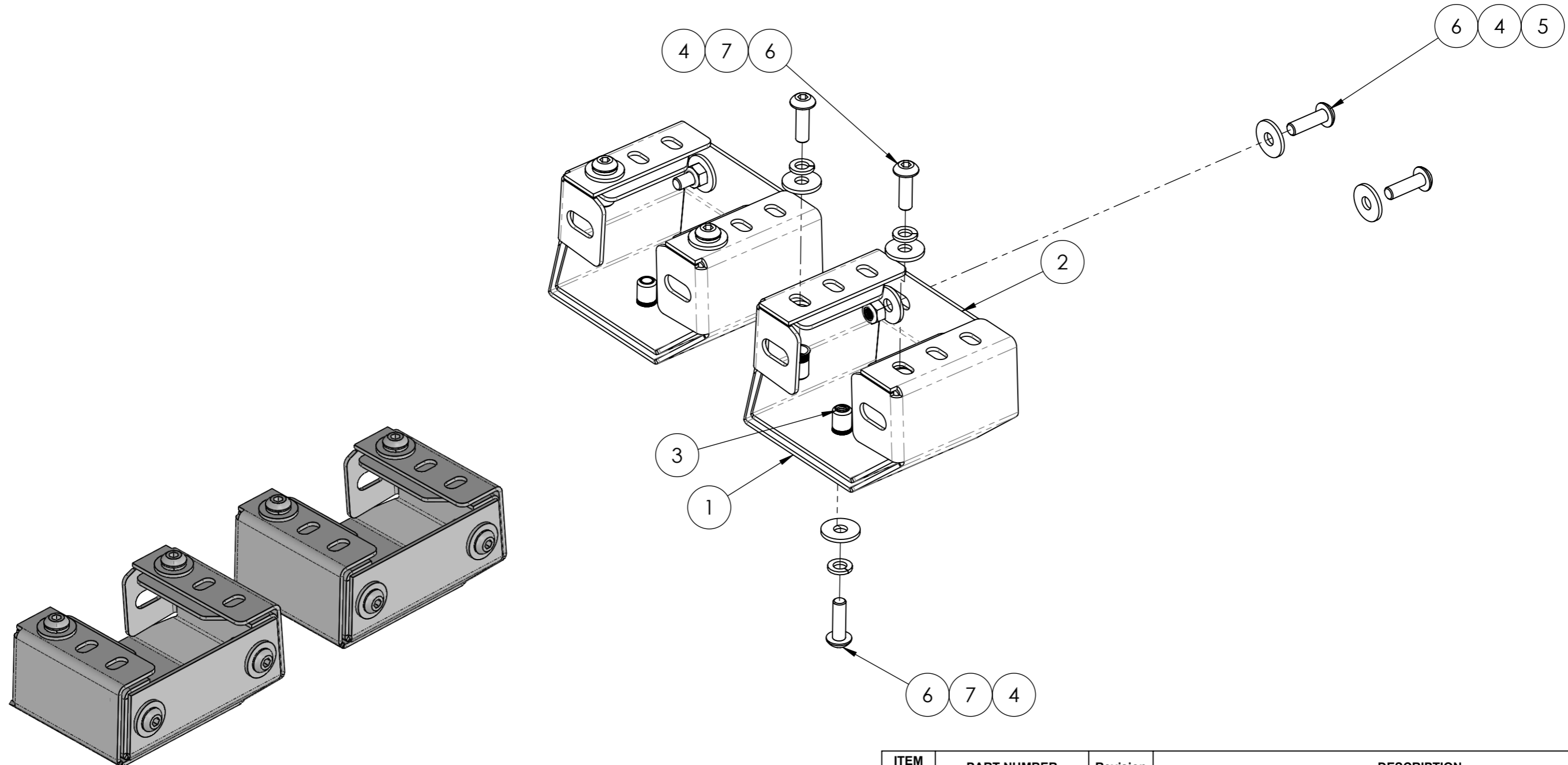

ITEM NO.	PART NUMBER	Revision	DESCRIPTION	QTY
1	A-MIR-EXT-P001	01	MIRROR EXTENSION - OUTER	2
2	A-MIR-EXT-P002	00	MIRROR EXTENSION - INNER	2
3	RIV-CSK-M6		M6 CSK RIVNUT	6
4	FFW-M6		M6x18mm OVERSIZED WASHER S/S - DIN 9021	14
5	NY-M6		M6 NYLOC NUT S/S	4
6	BHD-M6x20		M6x20 B/HD BOLT S/S	10
7	SW-M6		M6 SPRING WASHER S/S	6
8	BX-AC1	00	AC1 - BOX	1

REVISIONS			
REV.	DESCRIPTION	DATE	APPROVED
00	RELEASED FOR PRODUCTION	2022-08-18	System Administrator
01		2022-09-13	System Administrator

TOLERANCES TO ASSUME UNLESS INDICATED OTHERWISE

NOM DIMENSION	RANGE (mm)	TOLERANCE
0.50	- 3.00	± 0.10
3.00	- 6.00	± 0.15
6.00	- 30	± 0.20
30	- 120	± 0.30
120	- 400	± 0.50
400	- 1000	± 1.00
1000	- 1000<	± 2.00

DESCRIPTION: MIRROR EXTENSION FOR LAND CRUISER 76 & 78 (SET OF 2)

PROJECT: A-MIR-EXT

DRAWN BY: System Administrator DATE: 2022-08-18

SCALE: 1:2 SHEET: 1 of 1

DRAWING NO. A-MIR-EXT-PL

THE INFORMATION CONTAINED WITHIN THIS DOCUMENT IS THE INTELLECTUAL PROPERTY OF ALU-CAB (PTY) LTD

REV 01